

# Area Lighting Poles - Square Tapered

Catalog Number	Pole Height (ft)	Weight (lbs)	Gauge	Shaft Size (in)	Base Plate Width (in)	Bolt Circle Dia. (in)	Anchor Bolts (in)		Max Loading Capacities					
									80 (mph)		90 (mph)		100 (mph)	
							Dia x Len x Hook	Projection min / max	EPA (ft <sup>2</sup> )	Wt. (lbs)	EPA (ft <sup>2</sup> )	Wt. (lbs)	EPA (ft <sup>2</sup> )	Wt. (lbs)
STS-20-525-11-AB	20	155	11	5.25 x 3.05	10.75	10.75	1 x 36 x 4	4.5 / 5.5	18.0	450	13.8	345	10.7	267
STS-25-600-11-AB	25	205	11	6.00 x 3.25	11.5	12	1 x 36 x 4	4.5 / 5.5	16.8	420	12.6	315	9.5	237
STS-30-641-11-AB	30	260	11	6.41 x 3.11	11.88	12.5	1 x 36 x 4	4.5 / 5.5	13.6	340	9.8	245	7.0	175
STS-30-641-7-AB	30	375	7	6.41 x 3.11	11.88	12.5	1 x 36 x 4	4.5 / 5.5	23.6	590	17.9	447	13.7	342
STS-35-681-11-AB	35	305	11	6.81 x 2.96	12.25	13	1 x 36 x 4	4.5 / 5.5	10.7	267	7.3	182	4.8	120
STS-35-713-7-AB	35	475	7	7.13 x 3.28	12.63	13.5	1 x 36 x 4	4.5 / 5.5	23.4	585	17.4	435	13.0	325
STS-39-718-11-AB	39	345	11	7.18 x 2.92	12.63	13.5	1 x 36 x 4	4.5 / 5.5	8.6	215	5.4	135	3.0	75
STS-39-713-7-AB	39	500	7	7.13 x 2.87	12.63	13.5	1 x 36 x 4	4.5 / 5.5	19.3	482	14.2	355	10.4	260

## Pole Shaft

The pole shall be a one section design fabricated from standard 11 gauge (0.1196") or 7 gauge (0.1793") steel. Each section shall be fabricated from high strength low alloy steel with minimum yield strength of 50,000 psi. Each pole will have a full-length longitudinal weld and will be square in cross-section with a uniform taper of 0.11 inches per foot of length.

## Base Plate

The base plate is fabricated from a structural quality hot rolled carbon steel plate that meets or exceeds ASTM A-36 with a minimum yield of strength of 36,000 psi. The base plate telescopes the pole shaft and is circumferential welded top and bottom. The base plate has round bolt holes.

## Hand Hole

A reinforced hand hole, having a nominal 3" x 5" opening, will be installed 18" above the base plate on all poles. A hand hole cover and attaching hardware is included with each hand hole assembly. A ground lug will be welded either on the hand hole frame or on the inside of the pole opposite the hand hole depending on the design.

## Anchor Bolts

Anchor bolts are fabricated from a commercial quality hot rolled carbon steel bar that meets or exceeds minimum yield strength of 55,000 psi. Anchor bolts are sized according to each pole design and are furnished with 2 galvanized heavy hex nuts and 2 galvanized flat washers. Anchor bolts shall be galvanized a minimum of 4" on the threaded end in accordance with ASTM A-153. Anchor bolts will ship with the poles unless otherwise specified.

## Pole Top

Each pole will be side-drilled with a removable pole cap or have a 2-3/8" O.D. x 4" tenon top (other sizes available).

## Welding

All welds shall be of the highest quality and performed by American Welding Society certified welders conforming to the latest version of the American Welding Society specification AWS D1.1.

## Finish

All poles, mounting brackets and platforms are furnished with a coating of either red oxide/zinc primer, factory painted, powder coated or hot-dip galvanized to ASTM A-123. Miscellaneous hardware will be galvanized to ASTM A-153. Exterior finish coatings are available by request.

## Note

*Anchor bolt patterns are subject to change. Please consult factory prior to construction.*

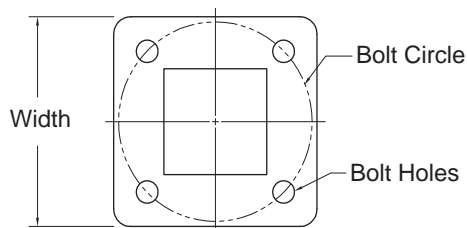

**Base Plate**

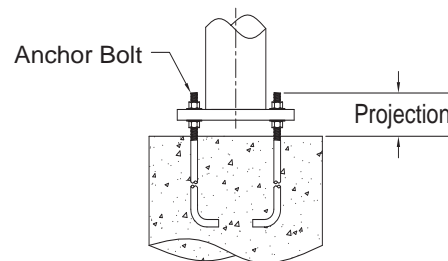

**Base Detail**